

DATE	REV	DATE	REV
10-21-02	CLAR 2P-03		

HOMIEPLANS
DESIGNED FOR TODAY'S MARKET

FIRST FLOOR PLAN
THE BIRKDALE

FBA
FRANK BETZ ASSOCIATES, INC.
240 LAKE PARK DRIVE/SUITE 250
SMITHS PAPER COMPANY BLDG
1770 431-0888
www.frankbetz.com

BY WVB CK KKW

DATE 12/5/01

SHEET
4
OF 7

GENERAL FRAMING NOTES

THE FOLLOWING NOTES ARE SUGGESTED MINIMUM REQUIREMENTS ONLY. DUE TO A VARIANCE OF CODES PER REGION PLEASE REFER AND COMPLY WITH ALL YOUR LOCAL CODES. CONSULT WITH LOCAL ENGINEERS FOR ALL STRUCTURAL REQUIREMENTS.

1. PROVIDE PURLINS AT MID HEIGHT OF ALL WALLS.
2. ALL JOISTS AND RAFTERS SHALL BE ALIGNED OVER STUDS BELOW.
3. ALL HEADERS SHALL BE 2-2X10s WITH 1/2" PLYWOOD FLITCH PLATE UNLESS OTHERWISE NOTED.
4. FRAMER TO INSTALL DOUBLE FLOOR JOISTS UNDER PARTITION WALL PARALLEL TO JOIST DIRECTION.
5. PROVIDE 1/4 CROSS BRIDGING AT MID POINT OF SPAN OR 8'-0" O.C. MAXIMUM IN ALL FLOORS.
6. ALL EXTERIOR CORNERS INSIDE AND OUTSIDE CORNERS SHALL BE BRACED WITH 1/2" CDX PLYWOOD. NAILING SCHEDULE SHALL BE 8d COMMONS AT 6" O.C. AT ALL EDGES AND 8d COMMONS AT 12" O.C. AT ALL INTERMEDIATE STUDS. (OPTION - APPROVED DIAGONAL CORNER BRACES BOTH DIRECTIONS AT ALL CORNERS).
7. ALL COLUMNS OR SOLID FRAMING SHALL EXTEND DOWN THRU ALL LEVELS AND TERMINATE AT THE BASEMENT FLOOR AND BE SUPPORTED BY A THICKENED SLAB, GRADE BEAM, OR FOOTING DESIGNED TO CARRY LOAD.
8. PROVIDE DOUBLE 2x8 STRONGBACK AT MID SPAN FOR CEILING JOISTS WITH SPAN GREATER THAN 10'-0".
9. PROVIDE COLLAR TIES AT UPPER 1/3 OF VERTICAL DISTANCE BETWEEN RIDGE BOARD AND CEILING JOISTS AT 4'-0" O.C. MAXIMUM.
10. HF VALLEY RAFTERS AND RIDGE BOARDS SHALL BE ONE "2x" SIZE LARGER THAN RAFTERS.
11. ROOF DECKING SHALL BE 1/2" CDX PLYWOOD MINIMUM.
12. WHERE PRE ENGINEERED FLOOR AND ROOF TRUSSES ARE USED, TRUSS MANUFACTURER MUST PROVIDE SHOP DRAWINGS WHICH BEAR SEAL OF REGISTERED ENGINEER IN STATE IN WHICH WORK IS TO BE PERFORMED.
13. ALL CEILING JOISTS AND RAFTER BRACING TO BEAR ON LOAD BEARING WALLS DESIGNED TO CARRY LOAD THRU ALL LEVELS AND TERMINATE AT BASEMENT FLOOR AND BE SUPPORTED BY THICKENED SLAB GRADE BEAM OR FOOTING DESIGNED TO CARRY LOAD.
14. ALL BASEMENT WALLS, BEAMS AND COLUMNS TO BE DESIGNED BY LOCAL STRUCTURAL ENGINEER AND MEET ALL LOCAL CODES.
15. ALL SOLID FRAMING, COLUMNS, BEAMS, ETC., TO BE DESIGNED BY LOCAL STRUCTURAL ENGINEER AND MEET ALL LOCAL CODES.
16. ALL FRAMED WALL DIMENSIONS ARE BASED ON 2 x 4 STUDS UNLESS OTHERWISE NOTED.

GENERAL NOTES

1. ALL WORK SHALL BE PERFORMED IN ACCORDANCE WITH ALL APPLICABLE NATIONAL, STATE, AND LOCAL CODES, REGULATIONS, AND FHA/VA MPS.
2. CONTRACTOR SHALL VERIFY ALL CONDITIONS AND DIMENSIONS AT SITE BEFORE BEGINNING CONSTRUCTION. ANY DISCREPANCIES SHALL BE REPORTED TO FRANK BETZ ASSOCIATES, INC. FOR JUSTIFICATION AND/OR CORRECTION BEFORE PROCEEDING WITH WORK. CONTRACTORS SHALL ASSUME RESPONSIBILITY FOR ERRORS THAT ARE NOT REPORTED.
3. ALL DIMENSIONS SHOULD BE READ OR CALCULATED AND NEVER SCALED.
4. ALL FOOTINGS TO BE BELOW FROST LINE (SEE LOCAL CODES) AND MUST REST ON UNDISTURBED SOIL CAPABLE OF HANDLING THE BUILDING. CONSULT LOCAL ENGINEER FOR PROPER FOOTING AND REINFORCING SIZES.
5. CONTRACTOR SHALL INSURE COMPATIBILITY OF THE BUILDING WITH ALL SITE REQUIREMENTS.
6. IF BACKFILL EXCEEDS 4' AGAINST ANY FOUNDATION WALL, REINFORCE AS PER CODE.
7. ALL FOUNDATION AND STRUCTURAL MEMBERS SHOULD BE VERIFIED AND STAMPED BY AN ENGINEER IN THE STATE WHERE CONSTRUCTION IS OCCURRING DUE TO A WIDE VARIANCE IN LOCAL CODES, SOIL BEARING CONDITIONS, FROST LINE DEPTH, GEOLOGICAL AND WEATHER CONDITIONS, ETC. THE CONTRACTOR IS RESPONSIBLE FOR ADJUSTING AND VERIFYING ALL STRUCTURAL DETAILS AND CONDITIONS TO MEET ALL LOCAL CODES AND TO INSURE A QUALITY AND SAFE STRUCTURE.
8. ALL WOOD, CONCRETE, AND STEEL STRUCTURAL MEMBERS SHALL BE OF A GOOD GRADE AND QUALITY AND MEET ALL NATIONAL, STATE, AND LOCAL BUILDING CODES WHERE APPLICABLE.
9. ALL COLUMNS OR SOLID FRAMING SHOULD BE DESIGNED TO CARRY LOADS AND SHOULD EXTEND DOWN THRU THE LEVELS BELOW AND TERMINATE AT THE BASEMENT FLOOR OR AT OTHER BEARING POINTS DESIGNED TO CARRY THE LOAD.

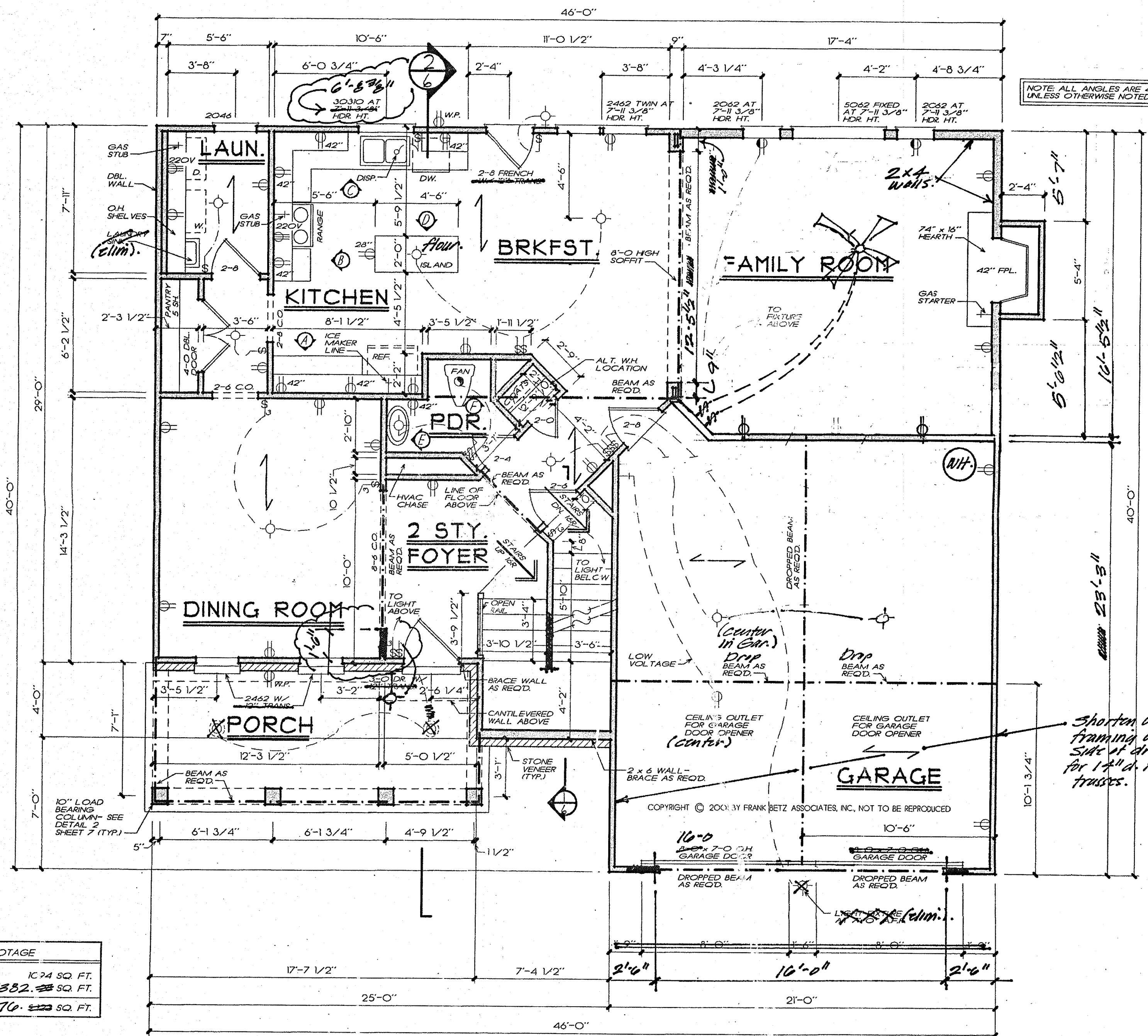

NOTE: ALL ANGLES ARE 45° UNLESS OTHERWISE NOTED

SQUARE FOOTAGE	
FIRST FLOOR	1074 SQ. FT.
SECOND FLOOR	1382. 222 SQ. FT.
TOTAL	2476. 222 SQ. FT.

FIRST FLOOR PLAN

1/4" = 1'-0"
FRANK BETZ ASSOCIATES, INC. ASSUMES NO LIABILITY FOR ANY CHANGES OR MODIFICATIONS MADE TO THESE PLANS BY OTHERS.

TIME: 2:45 PM DATE: 10-21-2002 PATH: NAME: X:\BOOK23\BIRKDALE\2222A04.DCS